

FR Flange

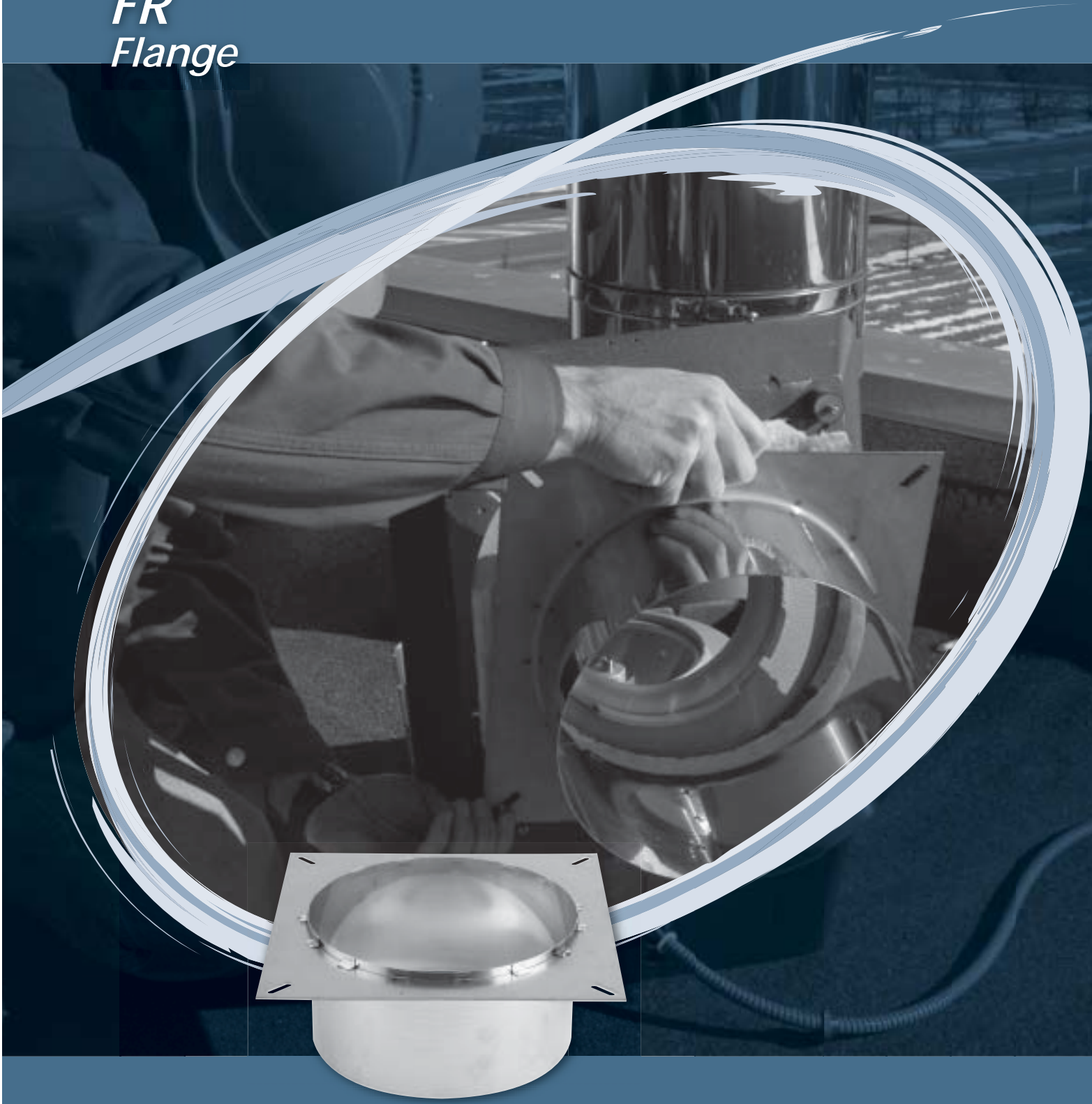

EXHAUSTO
FOR A BETTER FLOW



FR - Product information

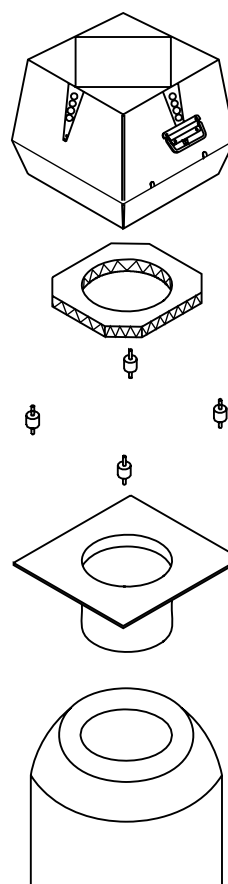

Description

EXHAUSTO flange type FR is used when installing an EXHAUSTO chimney fan on top of a twin-walled metal chimney. The flanges are made of stainless steel. The spigot of the flange FR is inserted into the flue. The glass fibre mat is placed on top of the flange with the aluminium foil facing upwards. A hole is cut corresponding to the ID of the flue/spigot. The fan and flange assembly is located on top of the chimney. Standard mounting is with anti-vibration bolts, these are supplied with the flange.

When using the anti-vibration bolts, the corners of the glass fibre mat must be cut off. The outer diameter of the spigot is 3 mm smaller than the inner diameter of the flue, e.g. flange FR1-200 has a 197 mm spigot, and hence fits a chimney ID of 200 mm.

The range offers alternatives to suit any fan model and most flue IDs.

Chimney Fan	Flange (mm)	Chimney ID									
		125	150	175	200	225	250	300	350	400	450
RSV009/160	240 x 240	FR1-125	FR1-150	FR1-175	FR1-200						
RSV012/200 RS009/255 RSVG200	310 x 310	FR2-125	FR2-150	FR2-175	FR2-200	FR2-225	FR2-250				
RSV014/250 RSHG012/014 RS012/014/285 RSVG250	395 x 395		FR3-150	FR3-175	FR3-200	FR3-225	FR3-250	FR3-300	FR3-350		
RSV016/315/400 RSV450 RSVG315	500 x 500				FR4-200		FR4-250	FR4-300	FR4-350	FR4-400	FR4-450

Length 120 mm

EXHAUSTO controls are supplied with a 2 year warranty. EXHAUSTO is certified according to ISO 9001.

EXHAUSTO Ltd.

Unit 3, Lancaster Court
Coronation Road
Cressex Business Park
GB-High Wycombe - HP12 3TD

Tel. 01494 465166
Fax 01494 465163
info@exhausto.co.uk
www.exhausto.co.uk

EXHAUSTO

FOR A BETTER FLOW

